

E-Wire

Setting Up PPPOE Connection

Create a PPPOE connection in Mac OS X 10.6

Raised By:

Function Code:

Date:

Version: 1.0

1.0 PURPOSE

1.1 To create a network connection to authenticate access to e-wire internet service using a username and password

2.0 Click the “**Apple**” icon to show the menu



2.1 Click the “**System Preferences**” from the menu



2.2 Click the “**network**” icon in system preferences



2.3 Click the **"Ethernet"** option from the list on the left

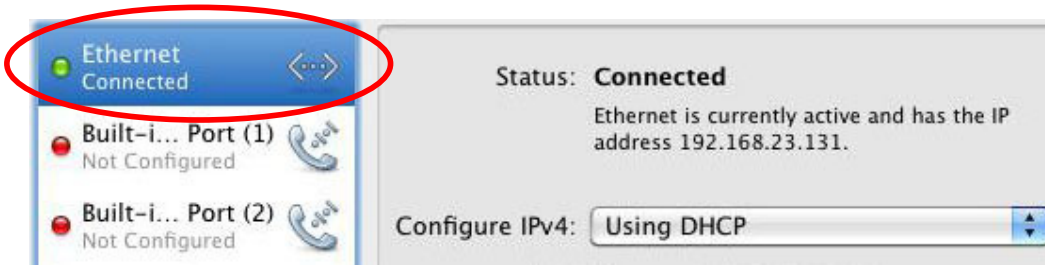

2.4 From the **"Configure"** dropdown, choose **"Create PPPoE Service..."**

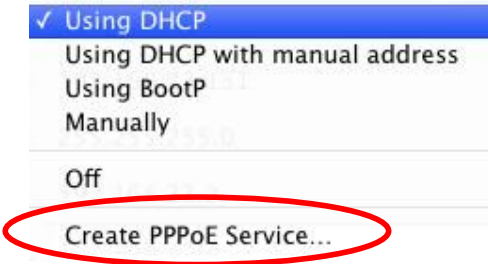

2.5 For the service name, enter **"E-wire"**
Click the **"Done"** button

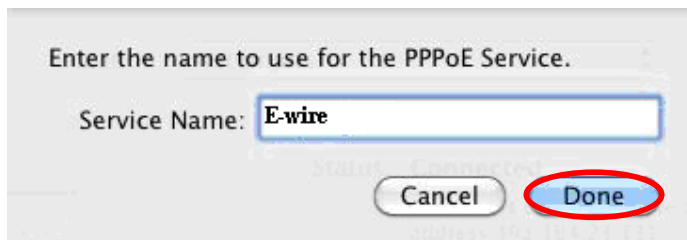

- 2.6 Click the new **"E-wire"** Connection from the list on the left
- Beside **"Account Name:"** type in your E-wire username. Remember (customer@e-wire.net.au)
- Type in your E-wire password in the **"Password:"** field
- Place a check in the **"Remember this password"** checkbox
- Place a check in the **"Show PPPoE status in the menu bar"** checkbox
- Click the **"Apply"** button
- Click the **"Connect"** button to start enjoying the internet

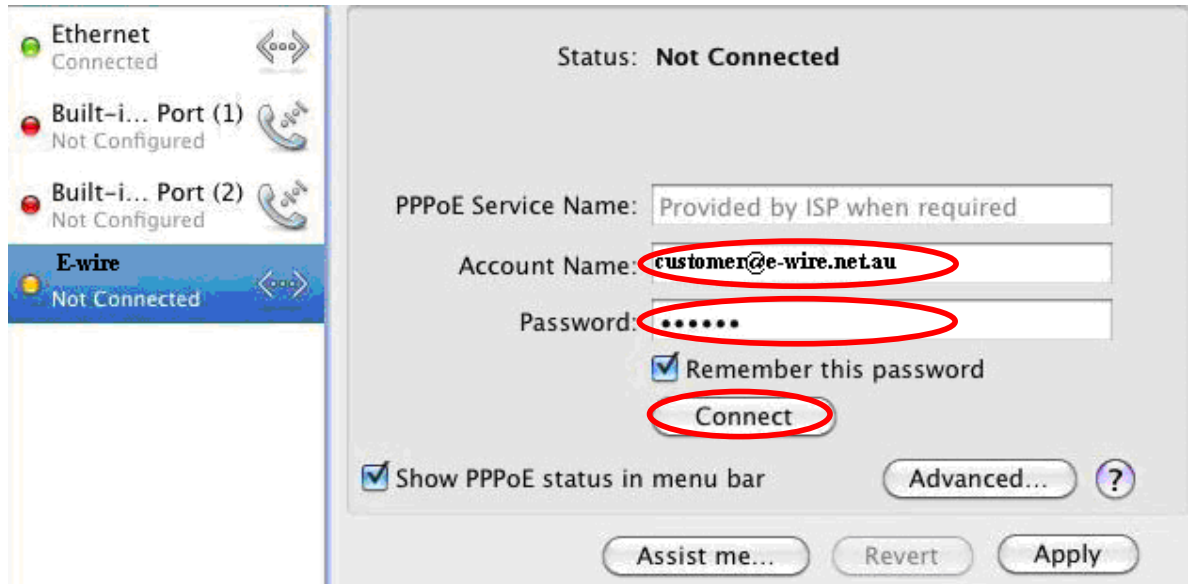

- 2.7 To connect later on (after you restart your computer)
- Click the Connection icon on the menu bar
- Click **"Connect E-wire"**

